

21

12

3

21

20

18

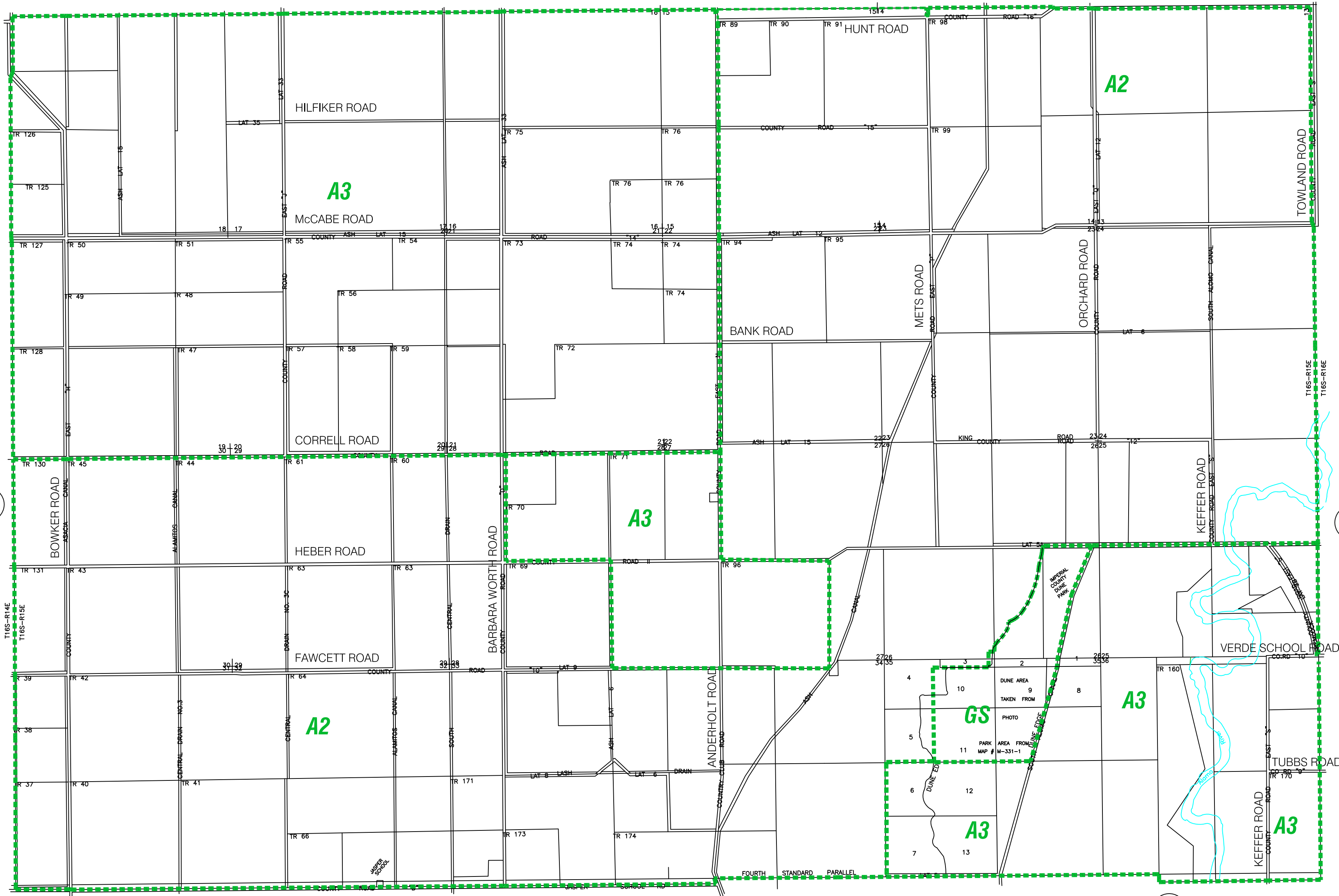

NOTE: Efforts have been made to insure zoning accuracy; however, this map may be revised at any time. Therefore this map is generally accurate, for zoning information only! Neither the County of Imperial nor the Planning/Building Department are responsible for erroneous information or improper use of this map. Adopted by M. O. # 15 (e) on Mar. 4, 1998 effective July 1, 1998.

Director \_\_\_\_\_

Revision Dates:

Dec. 17, 2008

# HEBER DUNES AREA

Title 9 Division 25 Section 92517.00

# MAP 17